

Single Color Steel Privacy Fence Installation Manual

Step-by-step guidance for planning and installing your fence.



BEFORE YOU START

- ✓ This installation guide does not cover fences above 1.8 metres. Please seek advice from your supplier.
- ✓ Describe your site details when ordering materials (see 'Important Site Details' below).
- ✓ Identify the soil type for your fence site. Refer to the table on the next page to determine the concrete required.
- ✓ Make sure you know the whereabouts of underground electricity, gas or water mains before you begin digging. Ring 1100 'Dial before you dig'.
- ✓ Check your local council regulations on boundary fencing.
- ✓ Ensure you read through this guide completely before you begin to ensure you fully understand the process.
- ✓ Check the delivered material for the correct number of components and general condition.



IMPORTANT!

- Long-term performance depends on getting the basics right.
- Use post holes of the correct size and filled with concrete as specified (see Step 2).
 - Use the recommended number of self-drilling screws when joining two posts together (see Step 2).



TOOLS*

- Self-Drilling Screw Gun with Clutch System (electric or battery operated)
- Spirit Level or Magnetic Level
- Rubber Mallet
- String Line and Marker Pegs
- Scissor Shovel and/or Spade
- Wheelbarrow and Larry Hoe
- Spud Bar
- Earth Leakage Circuit Breaker



PERSONAL PROTECTIVE EQUIPMENT*

- Safety Glasses
- Protective Gloves
- Hat & Sun Lotion for skin protection
- Appropriate Safety Footwear
- Ear Muffs (if cutting required)
- Overalls (if cutting required)



OPTIONAL EQUIPMENT*

- Nibbler (if cutting required)
- Tin Snips (if cutting required)
- Tungsten Tipped Handcutter (if vertical slitting of sheets required)
- Concrete Mixer

* Most pieces of equipment are available for hire at tool hire centres.



IMPORTANT SITE DETAILS

Fencing should be planned with your site conditions in mind. Consider the following factors:



SURROUNDING OBSTRUCTIONS

E.g., houses, trees, other structures, roads, canals. These impact wind exposure and access for installation.



WIND REGION

Wind conditions vary by location. Check your wind region to ensure your fence is designed and installed to perform in your area.



SITE EXPOSURE

If you are near severe marine conditions or near swimming pools, seek specific advice from Perimtec.

Step 1 – Marking Out Your Post Holes

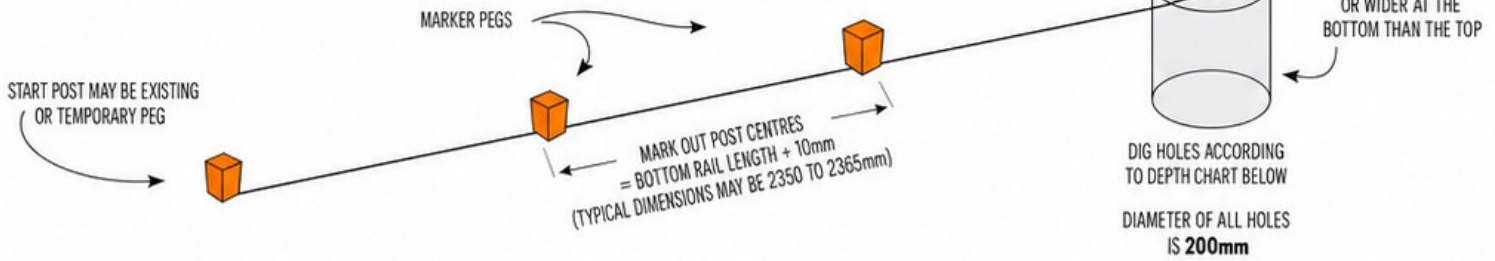

SOIL TYPE	MINIMUM HOLE DEPTH	APPROXIMATE CONCRETE REQUIRED (per hole – 20kg bag)
Rock	300mm	1 bag per hole
Clay/Firm Earth	600mm	2 bags per hole
Sand/Loose Fill	900mm	3 bags per hole

SLOPING OR UNEVEN SITES

a. Marking out sloping sites

b. Cutting sheets for a raked fence

IMPORTANT! It's highly recommended to rake your fence on sloping or uneven ground rather than stepping the panels. Post lengths may need to increase—allow for this when fixing posts in the ground.

IMPORTANT! It's highly recommended to rake your fence on sloping or uneven ground rather than stepping the panels. Post lengths may need to increase—allow for this when fixing posts in the ground.

Step 2 – Securing Posts

a. Fastening posts together

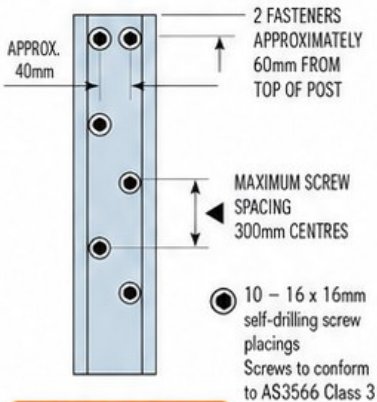

IMPORTANT! If it is not possible to fix posts as proposed here, please consult your distributor.

b. Fixing post in ground

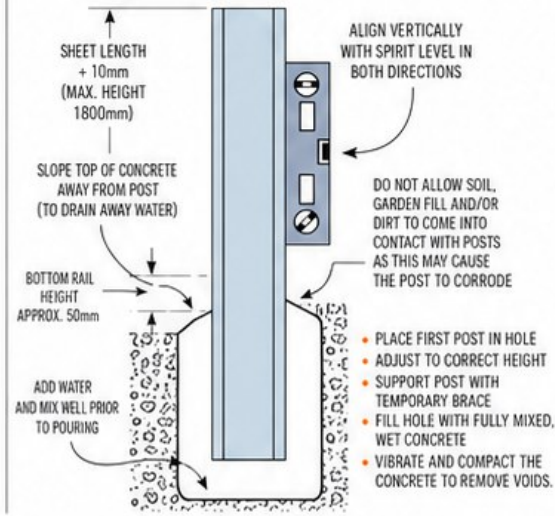

c. End posts, corner posts and junctions

□ = SHS Section ◻ = Fence Post
Dimensions of the SHS section and fence posts will vary according to the fence supplies. Contact your distributor for details.

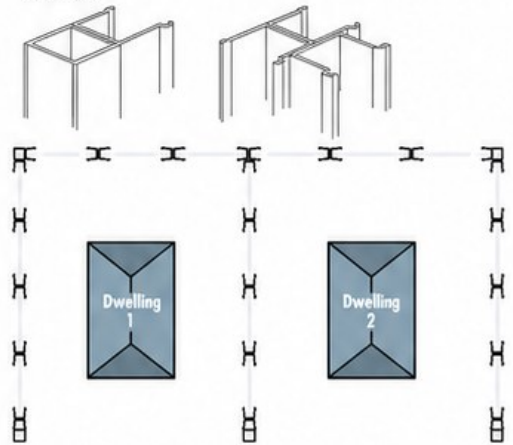

d. Tapering the front of your fence

It is highly recommended that you taper the last two panels of your fence at an unsupported end, particularly where your fence extends beyond the front of your house.

Cut sheets as per the instructions in the 'sloping or uneven sites' section.

The minimal extra effort in tapering the unsupported end will provide a better looking fence than a stepped fence and is much stronger than leaving it at full height.

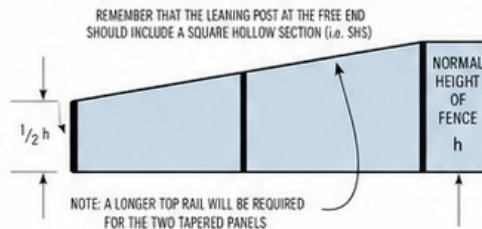

Example for 2365mm post centres	Fence Height	Tapered End Height	Top rail length if tapered per two panels
	1500mm	750mm	2385mm
	1800mm	900mm	2400mm

STEP 3

Installing Infill Sheets

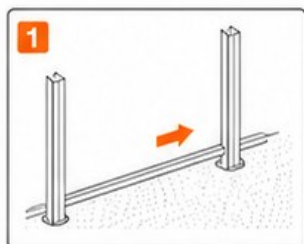

Insert bottom rail between posts to determine exact locations of next post.

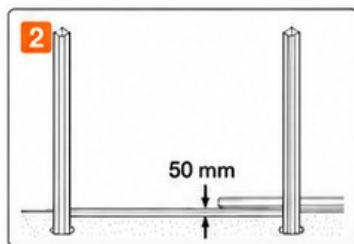

Adjust bottom rail to correct height – maintain a minimum gap of 50 mm between bottom rail and ground. Screw fix the rails.

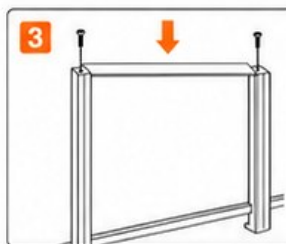

Place top rail into post and fix with self-drilling screws on both sides of posts. Do not fully tighten.



Allow the concrete to cure overnight. Longer curing may be required in very cold and/or wet weather.

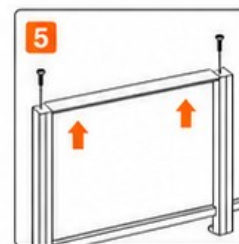

Unscrew top rail and remove.

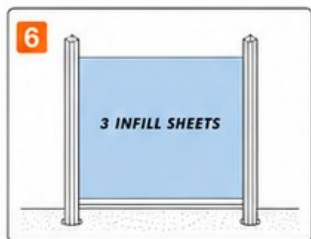

Fit infill sheets into bottom rail ensuring correct lap as per diagrams below.

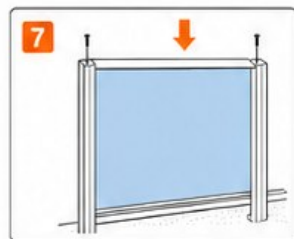

Place top rail on infill sheets working from one end to the other, locating the profile in the rail. A gentle tap with a rubber mallet may help.



Secure the top rail with self-drilling screws on both sides.

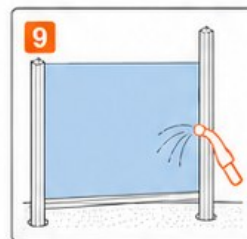

Hose down with good water pressure when finished to remove any swarf such as drill filings or remnants from the nibbling process.



Check installation.

CORRECT LAP DETAIL FOR VARIOUS INFILL SHEET PROFILES



NOTE: Continue this procedure until fence length is achieved. Protruding 2 mm above the top of the posts to reduce the risk of injury.

CARE & MAINTENANCE



1 KEEP IT CLEAN

To keep your fence looking its best, simply wash down periodically with water when cleaning the car or watering the garden. A soft broom should be sufficient to remove any cobwebs. Pay particular attention to the area under the top rail, which is sheltered from natural washing by rain.



2 KEEP SOIL AWAY

DO NOT build up soil, garden fill and/or dirt against the bottom rails and posts of your fence as this will retain water and lead to corrosion.



3 NOT A RETAINING WALL

DO NOT use your fence as a retaining wall, as it is not designed for this purpose.



4 AVOID SPRAYS

Avoid spraying the fence with garden sprays or fertilisers as these can damage the surface. If this occurs wash the fence down with water.



5 ENSURE DRAINAGE

Adequate drainage is needed to ensure that water does not pond in the bottom rail and to assist in the removal of debris. This is often achieved by pre-punched holes in the bottom rail, or by designing the posts such that there is a clearance between the ends of the bottom rail and the posts.



6 DO NOT USE TOUCH-UP PAINT

DO NOT use touch-up paint. Minor scratches should be left alone or the infill sheet replaced. Touch-up paint may weather differently than the original finish.



BACKED BY A 25 YEAR WARRANTY*

Fencing is backed by a 25-year warranty* under the following conditions:

- Installation must follow manufacturer guidelines
- Exposure conditions may affect warranty eligibility
- Regular maintenance is required
- See Perimtec for full terms and conditions.

* See Perimtec for full terms and conditions.



Reference, Warranty & Product Performance

Use this page as a final reference for installation completion, product performance, and warranty information.

✓ FINAL INSTALLATION CHECKLIST

✓ Posts are plumb, aligned and securely set.	✓ Top rail is installed and secure.
✓ Top and bottom rails are level and fixed.	✓ All screws are tightened and flush.
✓ Infills are installed with correct lap and orientation.	✓ Fence line is straight with consistent gaps.
✓ Self-drilling screws are installed and tightened on both sides.	✓ Site is clean and free of debris.
	✓ Handover complete and maintenance advice provided.

✓ WHY THIS STEEL FENCE SYSTEM PERFORMS

Perimtec steel fencing is engineered for long-term durability through a multi-layer protection process.



🏆 QUALITY & IDENTIFICATION

High-quality branded steel fencing should be verified by your supplier. Look for the Perimtec name on product literature, packaging or labels. For best results, ensure installation is completed in accordance with this guide and standard construction practices.

Ask your supplier if you're not sure.

📄 WARRANTY & TECHNICAL NOTES

- Warranty eligibility depends on correct product selection, installation, application and maintenance.
- Fencing must be installed in accordance with this guide.
- Exposure conditions (coastal, industrial, marine, etc.) may affect product performance.
- Regular cleaning and maintenance help maintain appearance and ensure long-term durability.
- Full warranty terms, conditions and exclusions are available from Perimtec.



25 YEAR WARRANTY*

Backed by Perimtec.
Built to last.

⚠️ DISCLAIMER

This guide provides general installation information only. Site-specific conditions, engineering requirements or local regulations may require professional advice. Perimtec is not responsible for improper installation.

🗨️ NEED HELP PLANNING YOUR PROJECT?

Our team is here to help with expert advice and support.

📄 REQUEST A QUOTE

📍 Perimtec LLC
1659 Shawnee Rd., Waxahachie, TX 75165
☎️ (888) 995-8077
✉️ info@perimtec.com
🌐 www.perimtec.com